

T48N R99W

48099

PAGE REFERENCE:

49100	49099	47100
48100	48099	N/A
47100	N/A	N/A

This map is for informational purposes only. The location and extent of roads, accesses, and property lines depicted hereon do not guarantee legal right of passage, ingress and egress, or property boundaries.

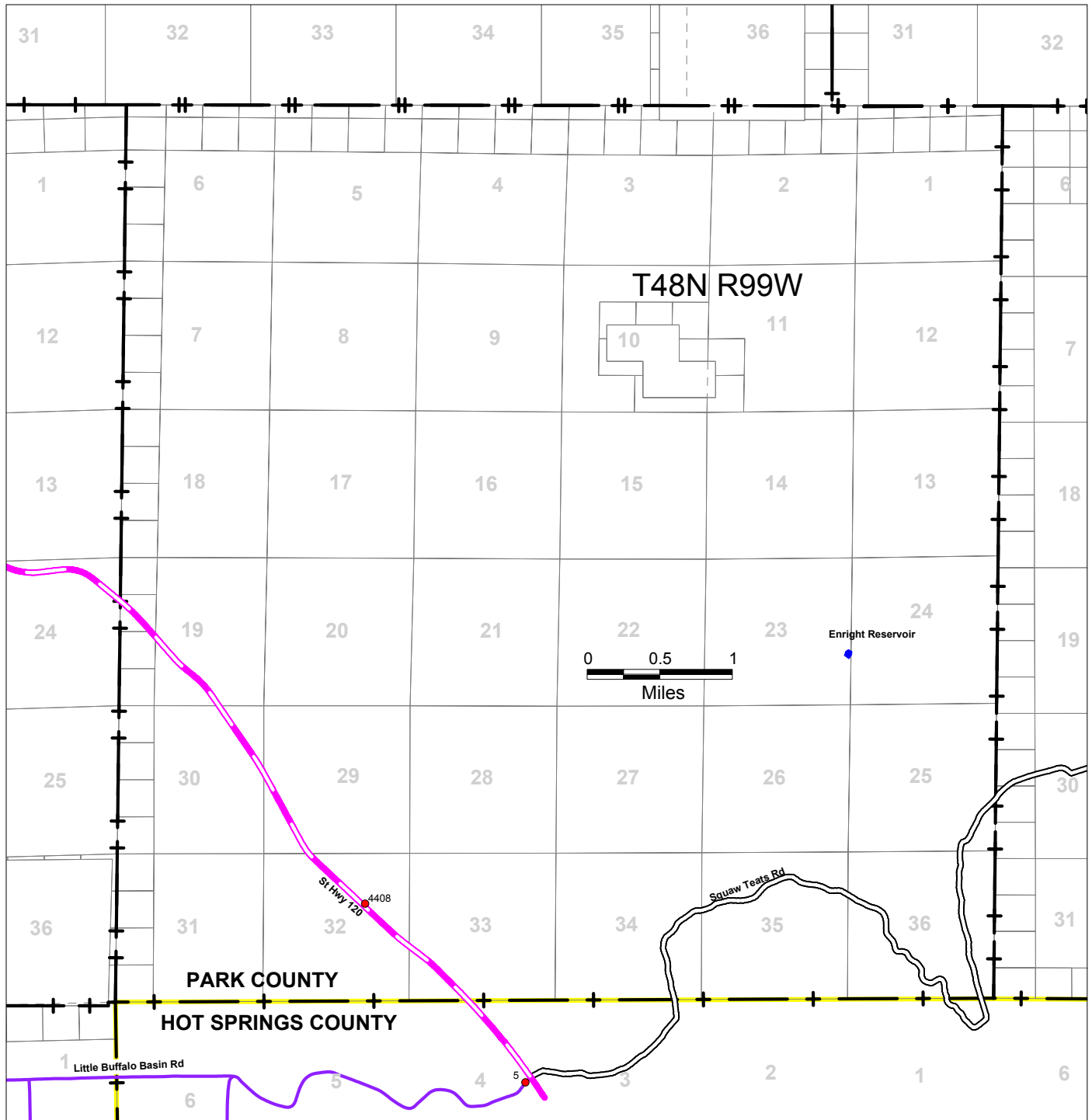

- County Maintained
 - Chip Sealed
 - Dirt (various grades)
- State Maintained
 - Chip Sealed
 - Forest Service Maintained
 - Dirt (various grades)
 - Private Road
 - various surfaces

